

HOW TO LOG IN TO YOUR GST ONLINE LECTURES

1. Open your web browser (e.g. Mozilla, Chrome, etc)

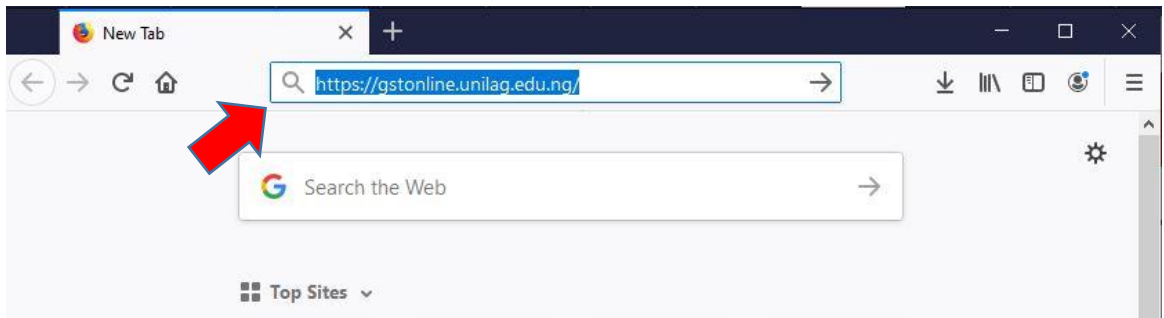

2. Go to the url: <https://gstonline.unilag.edu.ng>

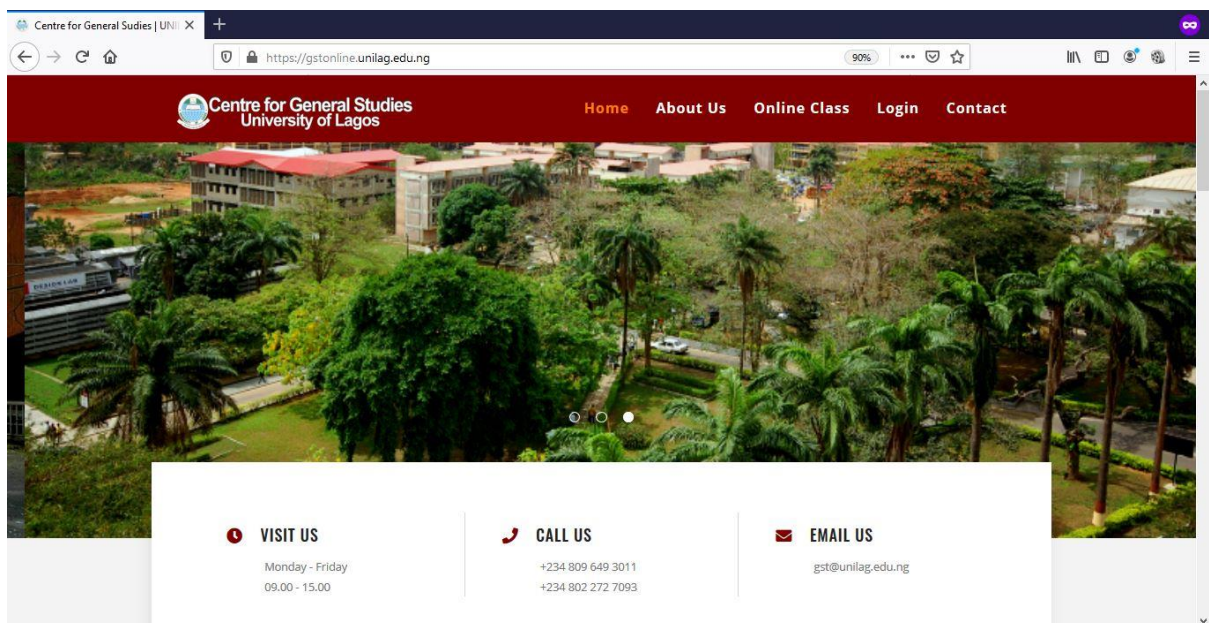

3. Click on **Online Class**

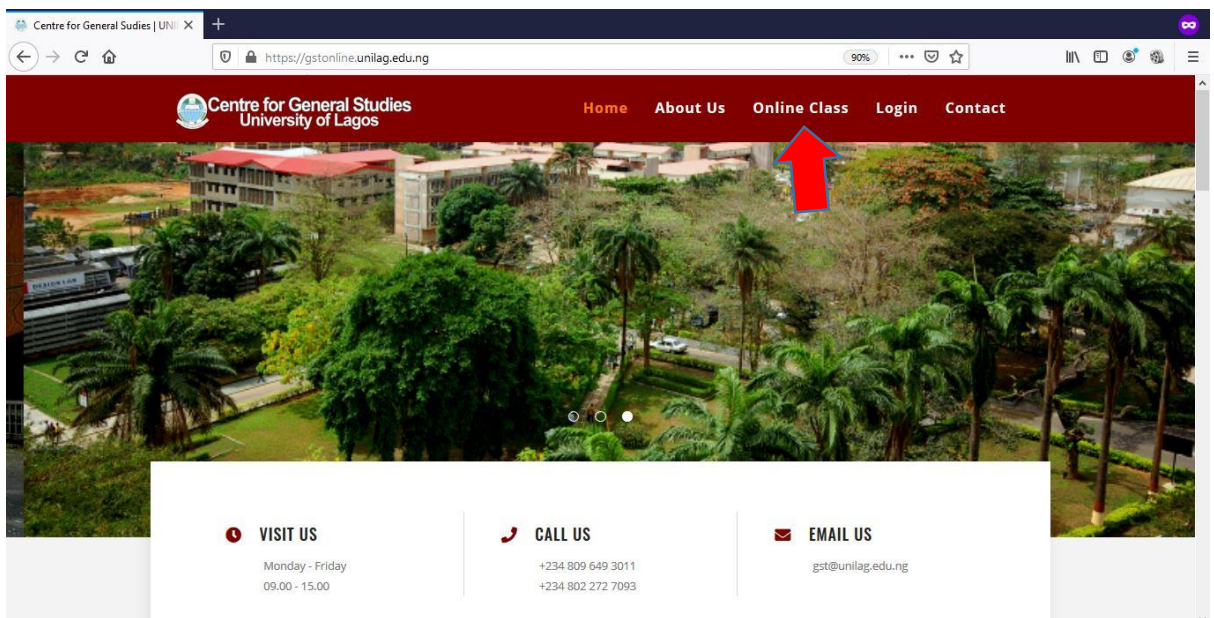

4. Click on **“Click here to Login”** on the homepage

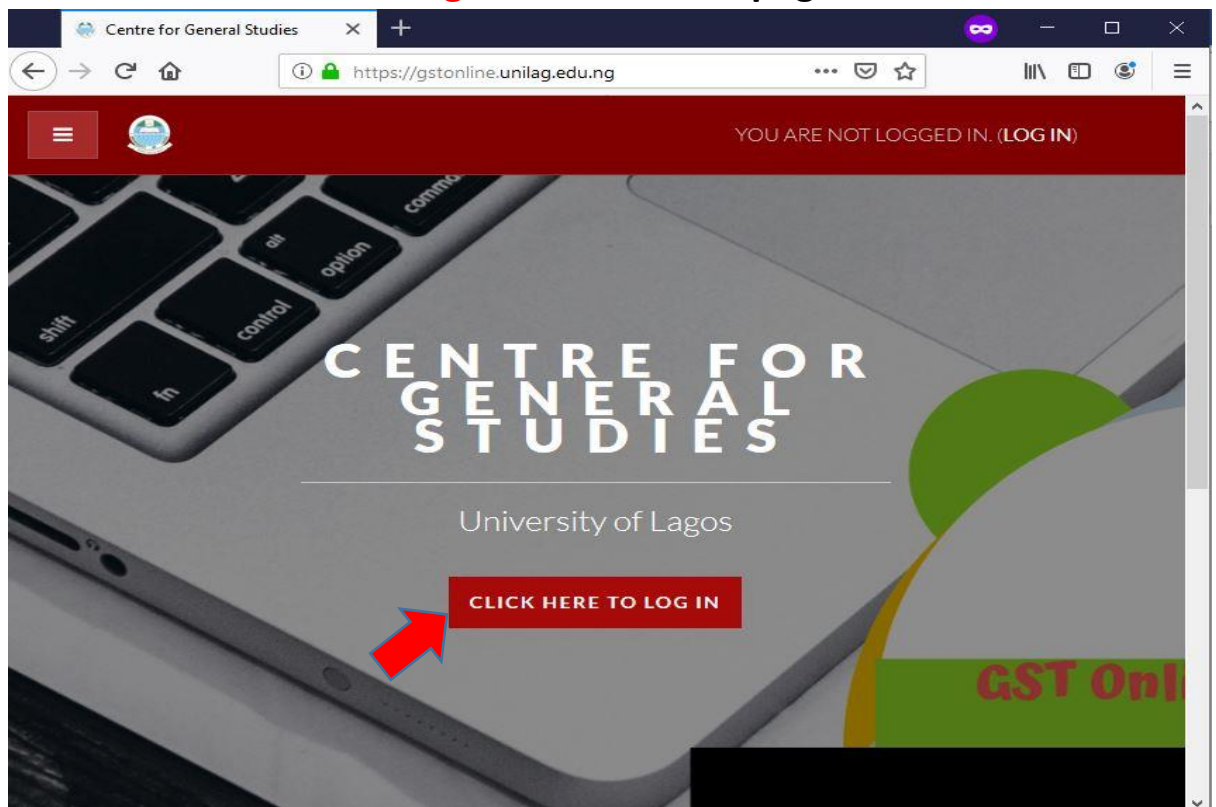

5. Click on **LOGIN WITH MICROSOFT ACCOUNT**

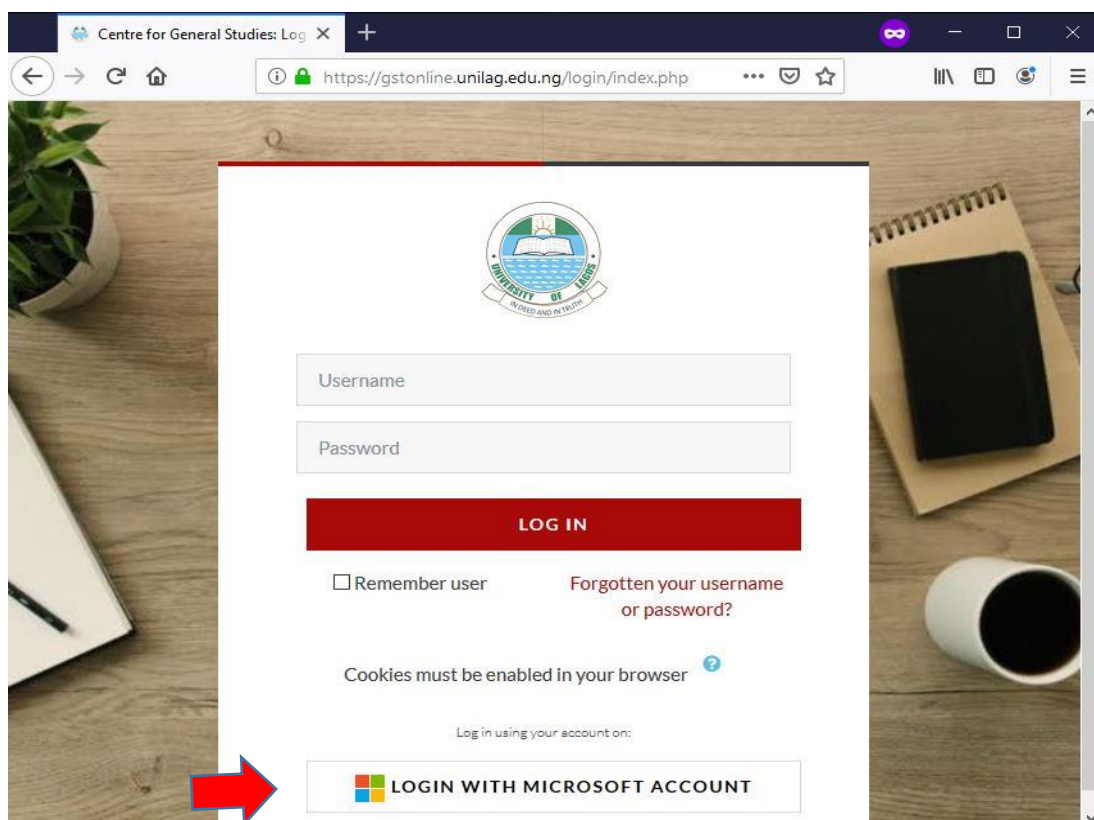

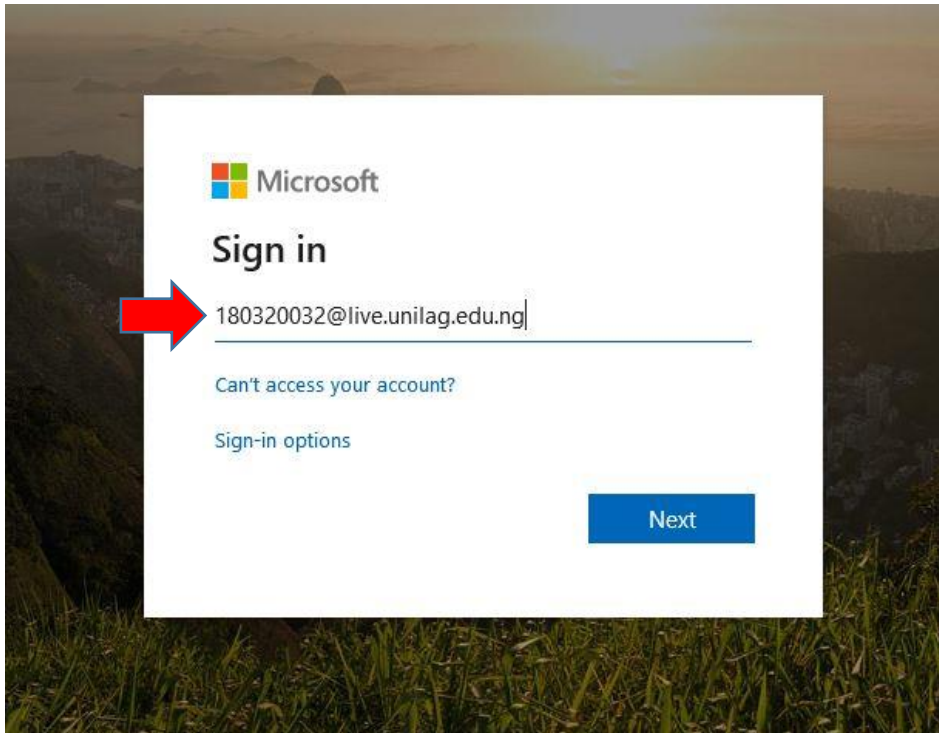

6. Enter your Microsoft account email which is [Matric_No@live.unilag.edu.ng](mailto:180320032@live.unilag.edu.ng) and click button **Next**

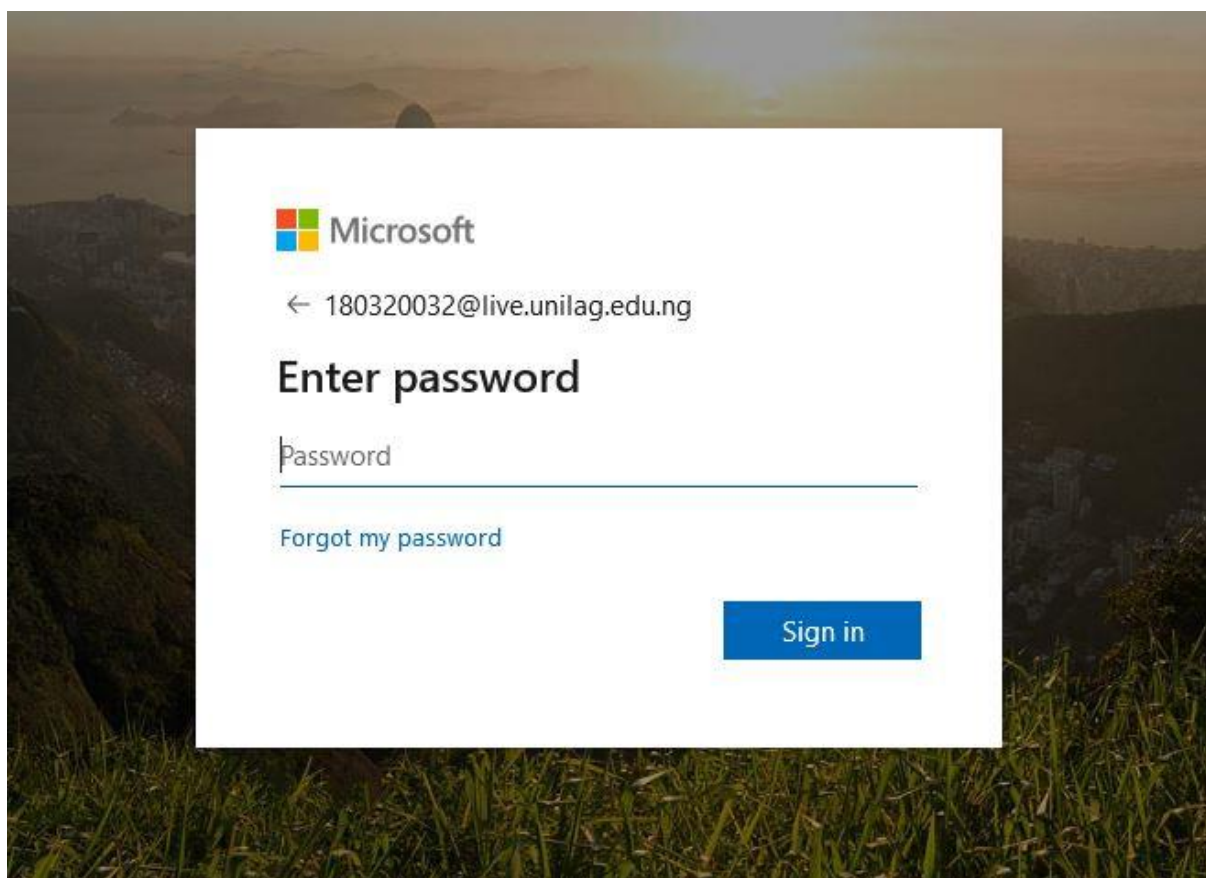

7. Enter your **Microsoft Account Password** and click button **Sign in**
8. Click on the course to access your lecture materials and videos.

9. Ensure to check on your course page **regularly**. The Lecturer of the course can post assignments, tests or any other class activity at any time.
10. Ensure to check the duration of the Test. The Lecturer may not extend the time set for the test.